



## Service Manual KE-640

### Potentiometer replacement

**Before beginning this task, switch off the machine and pull out the mains plug from the mains socket!**

#### Step 1 / 2 / 3

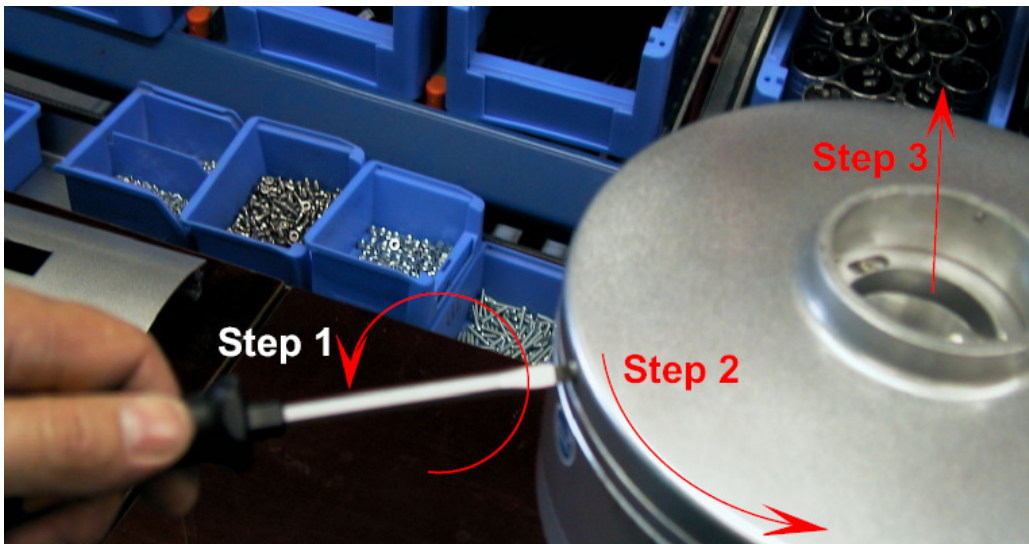

#### Step 4

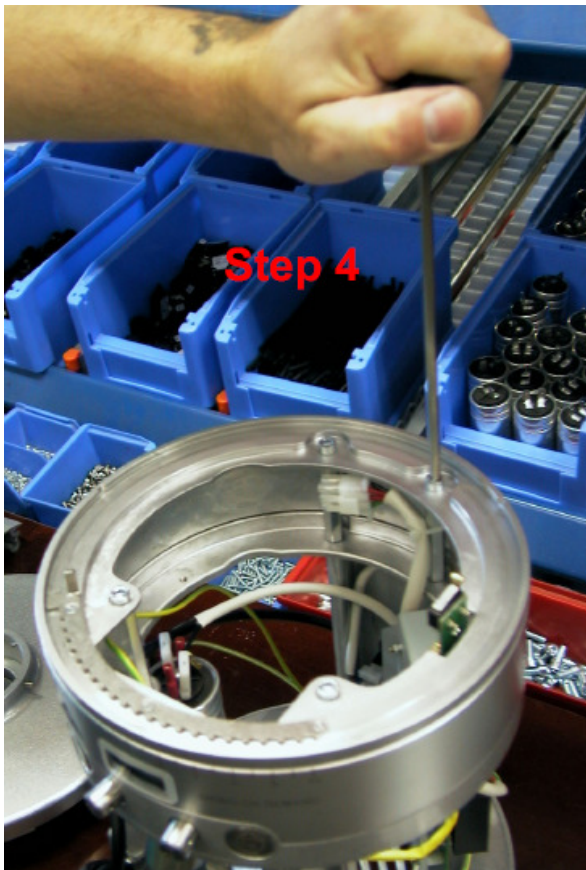



### Step 5

Remove the 4 screws see step 4

### Step 6

Disconnect all connectors on the circuit board  
(see picture on the right)

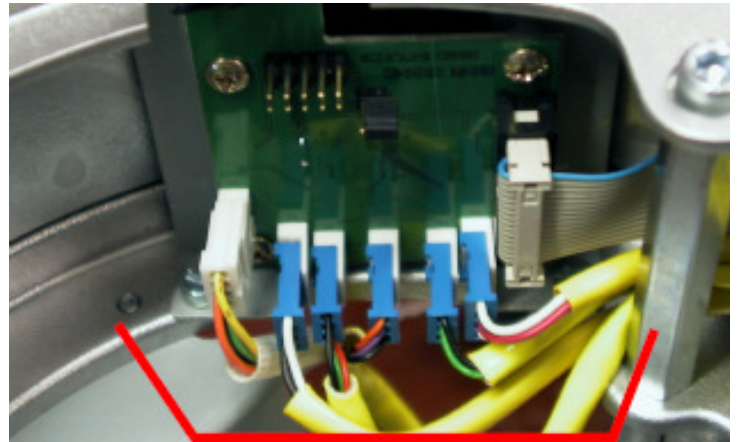

### Step 7

Remove the middle ring with the deco ring  
(see picture on the right)

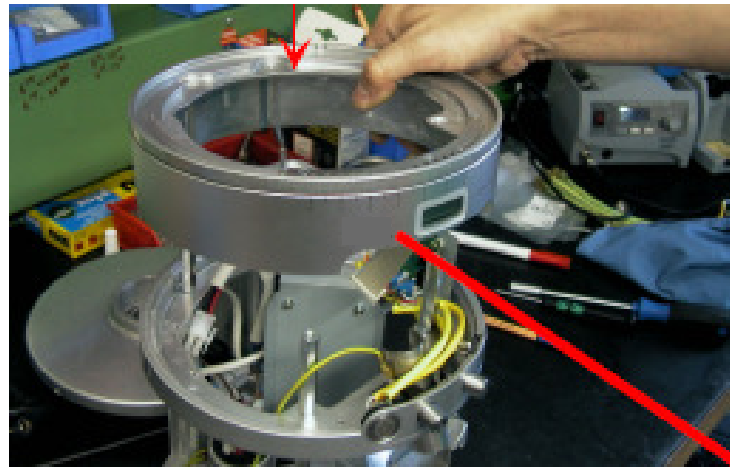

### Step 8

Unscrew and remove the spout

### Step 9

Unscrew and remove the timer/adjusting knob(s)

### Step 10

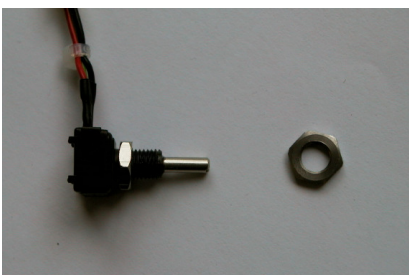



### Step 11



### Step 12



### Step 13

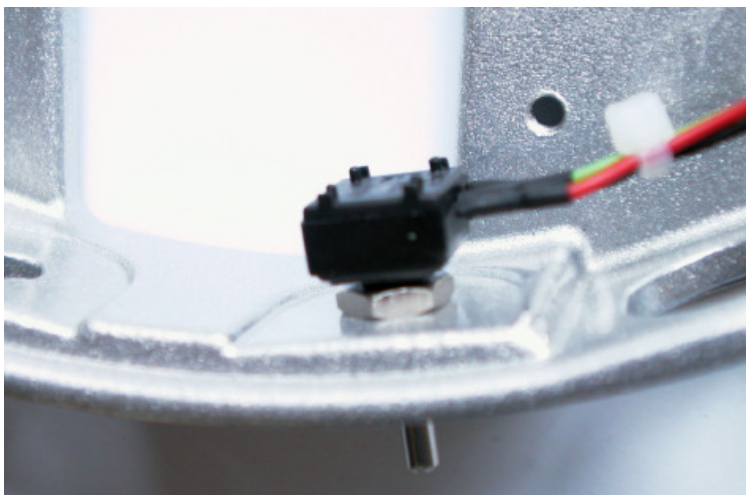



## Step 14



## Step 15

Reassemble all the parts in reverse sequence

12.01.06 // bg